

## THE WINDOW

Natalie Guy

23 May - 16 August 2020

*The Window* by Natalie Guy is an artwork inspired by two chapels, the Roman Catholic chapel Notre-Dame du Haut in Ronchamp, France (1954) and the Futuna Chapel in Wellington, Aotearoa New Zealand (1961).

The artwork was inspired by the interaction between light and space. When sunlight enters through the glass window to the left of Natalie's work, various shadows will appear on the work. The shadows will change throughout the day, depending on the sun's movement.

### ACTIVITY ONE

Many churches around the world have stained glass windows. A stained glass window is made up of pieces of coloured glass that are arranged to create a pattern or picture.

In the frame to the left, draw your own stained glass window. Start by drawing the outlines of a picture or pattern, then, colour it all in.

What kind of window would you like to see every day? What colours would you like to see when the sun shines through your window? Will your stained glass window be a pattern or a picture?

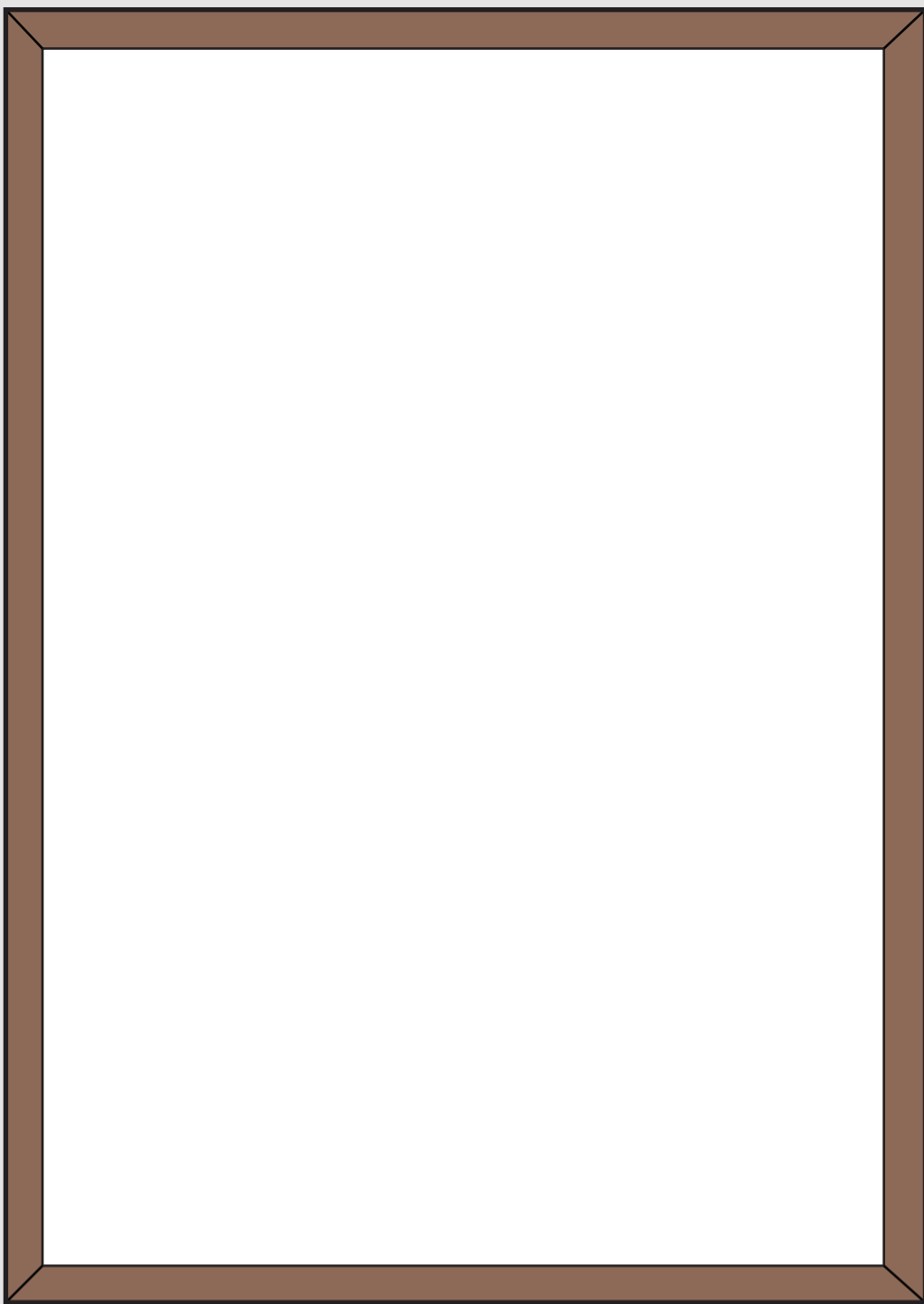

### ACTIVITY TWO

Natalie's artwork consists of multiple metal window frames. The artist has used these frames as lines, to construct each shape.

Can you see which windows are missing from the drawing below? Look at Natalie's artwork and draw in those that are missing, to complete the image.

Now, see if you can draw the projection and where it is located on the wall!

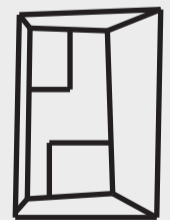
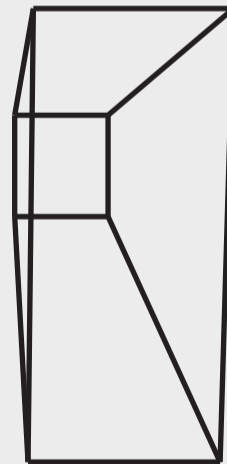
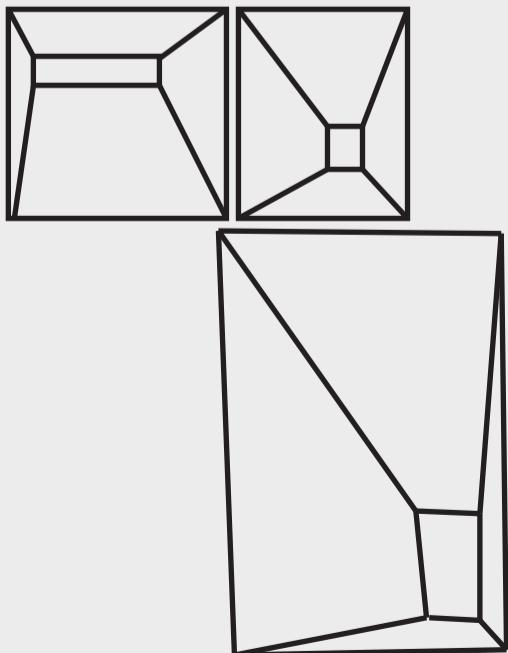

### ACTIVITY THREE

The triangular shape below is in the design of the windows from the Futuna Chapel, built in 1961. The design is very colourful. The way sunlight shines through the Futuna Chapel windows inspired Natalie to make a projection. In Natalie's projection, colour moves across the wall throughout the day.

Colour in the shapes in the Futuna Chapel window. The shapes are outlined to help show you what colour each is.

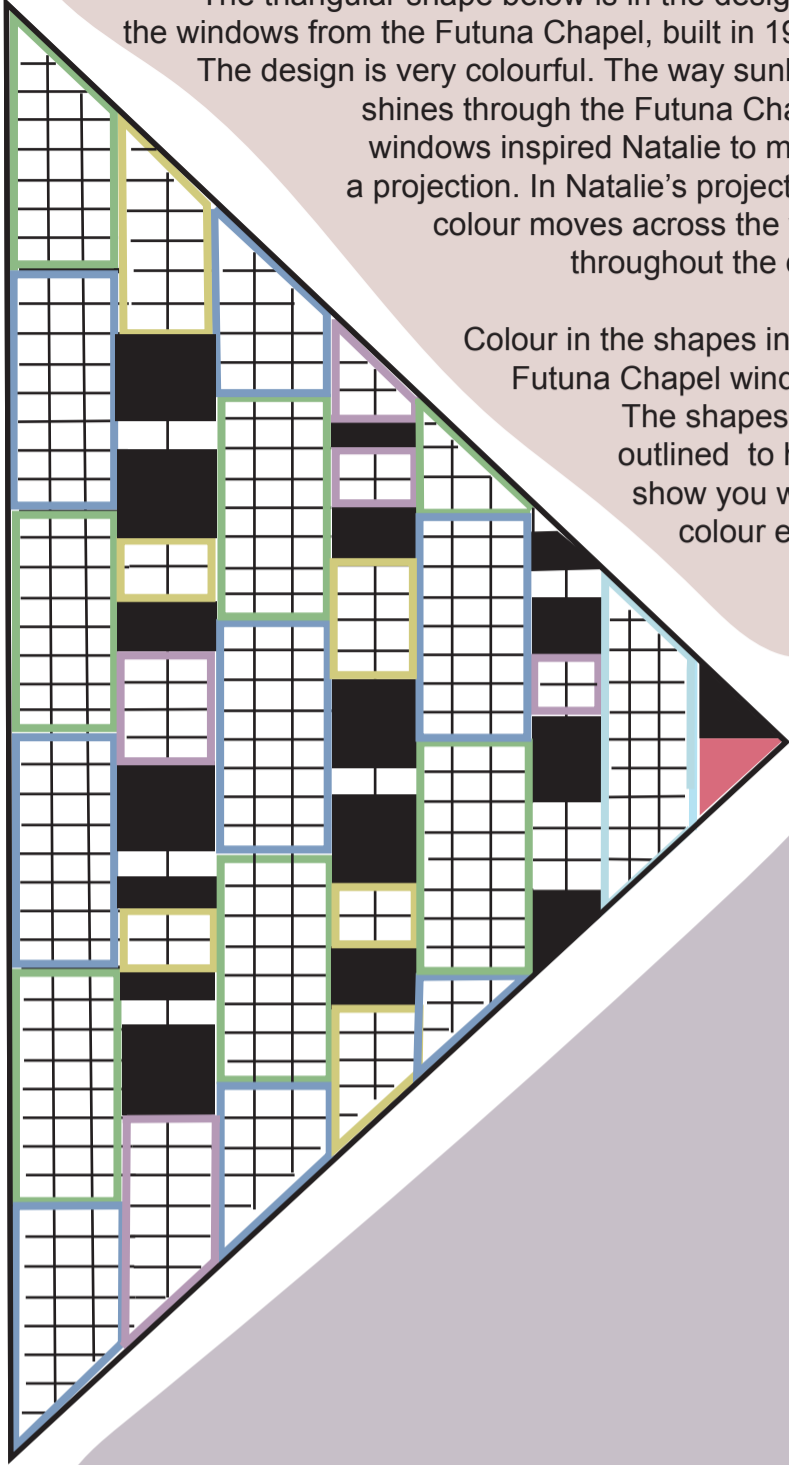

### ACTIVITY FOUR

Windows can come in many shapes, sizes and colours. They may be found in many different situations.

Draw a range of objects, places, or vehicles that have windows. Think about where you live, and what kinds of transport vehicles have windows. These might fly high in the sky or travel deep into the ocean...

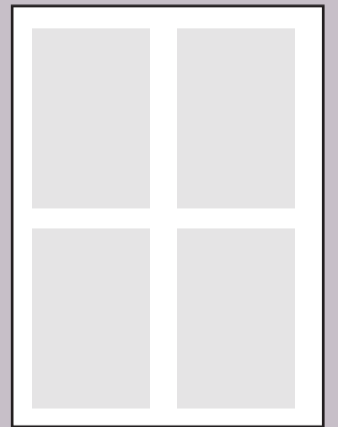

### ACTIVITY FIVE

This is drawing of the Roman Catholic chapel Notre-Dame du Haut, built in 1954. To the left of the building is a cluster of square and rectangular shaped windows. What words would you use to describe the way Natalie has arranged the window frames in her work?

\_\_\_\_\_

How many windows can you count on the Notre-Dame du Haut?

\_\_\_\_\_

Now, colour me in!

